



FLUSHCONTROL[®]

Instructions for power supplier (adaptor)

Plasson Wall unit operates on 12V DC. Therefore a power supply adaptor must be used before plugging to the wall socket. Please follow the instructions below.

1. Cut off the adaptor end plug and expose 5mm of the internal wires.



2. Insert cable through the PG and wire to the green connector marked POWER 12V (for easy wiring green connector can be pulled out). **Please note - Polarity applies.**

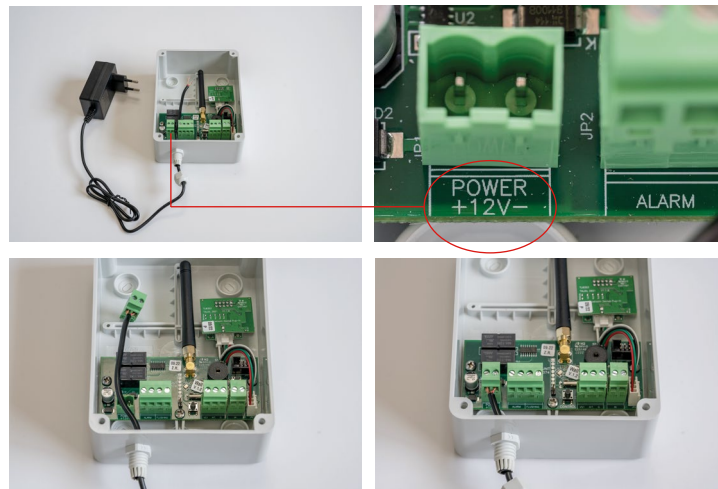

3. Tighten the PG and close the box cover with the screws.

