

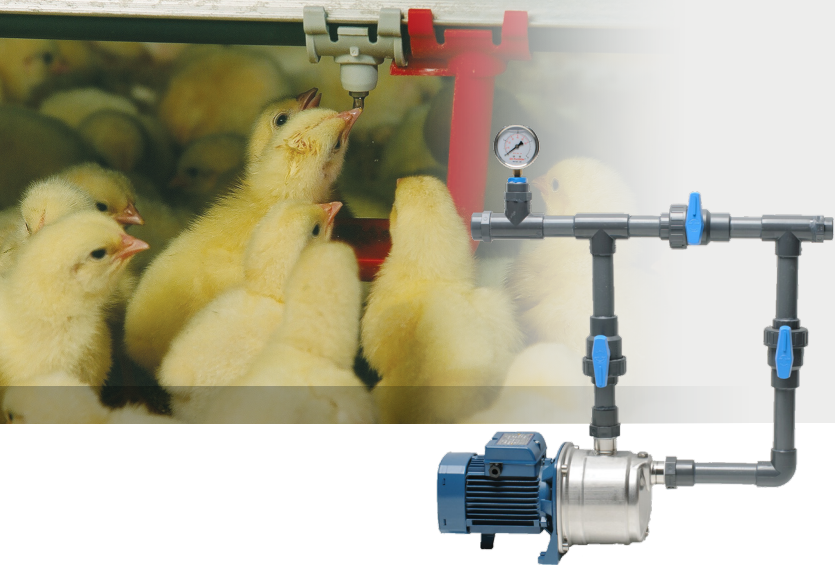







Reducer Retrofit Kit



 **Water on Demand**
Precise Day Round Water Consumption **PRO**

Pressure Regulator Conversion to Pressure Reducer

| | Cap | Washer | Diaphragm |
|----------|---|---|---|
| Existing |  |  |  |
| New |  |  |  |

The PLASSON Pressure Regulator (head or mid line) is converted easily into a Pressure Reducer by replacing three parts:

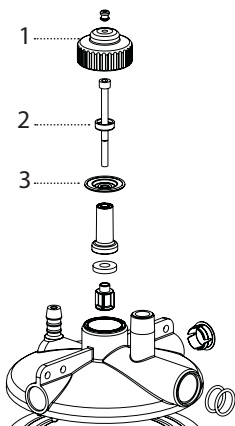

1. Cap for Pressure Regulator (02205709) is replaced by Reducer Cap (02205873).
2. Washer for Small Diaphragm (02205708) is replaced by Reducer Washer (02205874).
3. Black Diaphragm (02205716) is replaced by Grey Diaphragm (02205662).

Follow Steps 1 to 14:

1. Close the 1/4 turn valve on top of the regulator

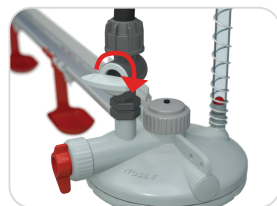

2. Drain the water from the line or raise the pressure regulator slightly to allow the water to drain from the regulator into the line

3. Open the regulating knob to the end (in lowering pressure direction)

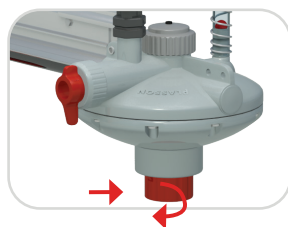

4. Unscrew the cap on top of the pressure regulator. If needed use a strap wrench (as shown)

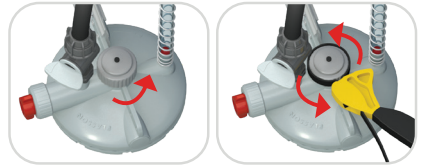

5. Unscrew the M6 bolt using a 5mm allen key

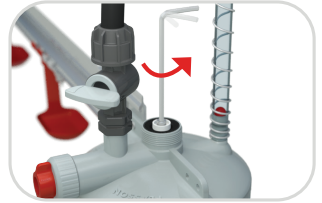

6. Take the bolt out

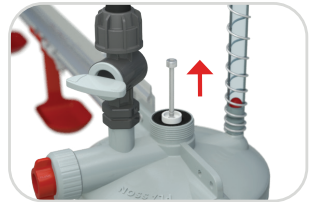

7. Take out the small regulator washer

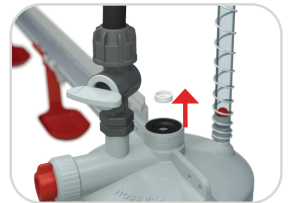

8. Replace the black diaphragm with the new grey diaphragm (orientation as shown)

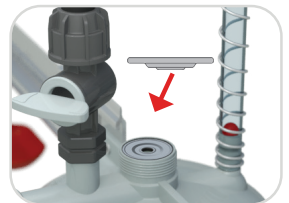

9. Replace the small regulator washer with the new Reducer Washer as shown

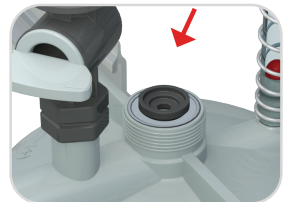

- 10.** Hand tighten the M6 bolt using an allen key (#5) while holding the long part of the allen key as shown (Stop at the point you can't tighten any more)

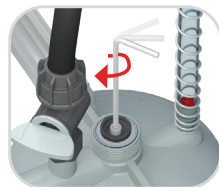
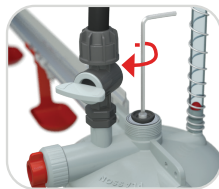

- 11.** Final tightening to be done by turning the allen key another 3/4 turn (clockwise)

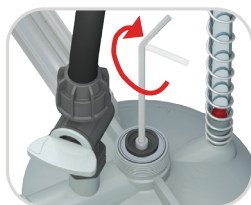

- 12.** Check that the small diaphragm is in place. Screw the new Reducer Cap (black) into place

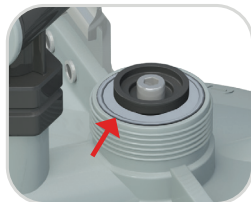

- 13.** Hand tighten the Cap (It is not necessary to use any wrench)

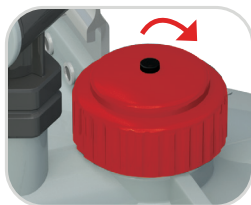

- 14.** Return the Reducer to the original height. Open the incoming water and check for any leakage. If leaking, tighten the Reducer Cap until the leakage stops

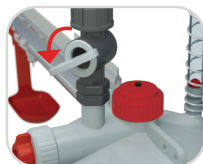
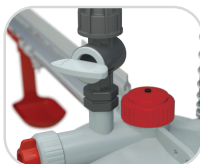



Reducer Retrofit Kit

Cat. No. 02205339

To be used only as part of PLASSON'S
Water on Demand &
Water on Demand Pro system

International Patent Application
PCT/IB2011/051077



Feeding



Drinking



Climate



Housing