



CONTROL PAN SELECTOR SWITCH

Installation Guide



Copyright © 2022 Plasson, all rights reserved.

Rev A | Doc P/N: 080205042E

Global Presence - Local Commitment



Feeding



Drinking



Climate



Housing

Table Of Contents

Safety

- » Safety Overview
- » Safety Conventions
- » Cautions and Warnings
- » Storage, Transport, and Installation
- » EMC Safety

Introduction

Assembly Instructions

Wiring Instructions

Components List

1. Safety

This chapter contains an overview of the pan feeder system safety concerns and includes:

- [Safety Overview](#)
- [Safety Conventions](#)
- [Cautions and Warnings](#)
- [Storage, Transport, and Installation](#)
- [EMC Safety](#)

1.1 Safety Overview

Plasson's pan feeder system has been designed to meet all known safety requirements. During normal operation, the pan feeder system presents no hazards to the operator or other personnel. However, in certain circumstances, the following potential hazards to operators and maintenance team personnel exist:

- Electrical shock (220 VAC)
- Mechanical hazard (moving parts, pinch points, etc.)
- Overhead hazard
- Heavy object hazard

The information and instructions presented in this document are intended to help personnel work with the pan feeder system in a safe, effective, and efficient manner.

1.2 Safety Conventions

Safety information is presented as follows:

<div> CAUTION</div>
<p>Caution is the signal word used to indicate a potentially hazardous situation which, if not avoided, could result in minor or moderate injury. It may also be used alert against unsafe practices.</p>
<div> WARNING</div>
<p>Warning is the signal word used to indicate a potentially hazardous situation which, if not avoided, could result in death or severe injury.</p>
<div> DANGER</div>
<p>Danger is the signal word used to indicate an imminently hazardous situation which, if not avoided, will result in death or severe injury. This signal word is limited to the most extreme situations.</p>

1.3 Cautions and Warnings

The following instructions and guidelines are necessary to ensure safe operation and long system life. Before performing any work on the system, become familiar with the following safety sections:

1.3.1 General Safety Cautions



CAUTION

- Read the installation and operation instructions prior to installing or before servicing the system.
- Before working on the system, read all safety standards and instructions to avoid injury or damage to equipment or property.
- Electrical connections must be serviced by a qualified electrician, using certified components only, and according to local regulations and standards.
- Shut off the system before conducting system maintenance.
- Proper operation of the system is not guaranteed if unauthorized parts are used.
- In case of unusual or irregular noise or vibration, it is necessary to switch off the system.

1.3.2 General Warnings

 **WARNING**

- **Hazardous Voltage:** Contact with electrical equipment can cause electric shock or burn if the power supply is turned on. Before starting any work on electrical equipment, disconnect the machine from the power socket.

1.4 Storage, Transport, and Installation

 **CAUTION**

Installation safety:

- The operator is responsible for the equipment and must not allow unauthorized persons to use the system or be in its vicinity.
- Whenever you handle or repair the equipment, turn off the power supply first.
- Maintenance and repairs must be carried out by qualified technicians authorized by Plasson.
- Always use Plasson components when replacing any defective components.
- All electrical parts must be grounded and installed by a qualified electrician.
- Pay close attention to the safety symbols on the components, as carelessness can lead to serious injury and even death.

 **CAUTION**

Storage safety:

- Ambient temperature must be between 5°C and 60°C.
- System must not be exposed to humidity, rain, condensation, dust, or direct sunlight during storage.

Transport safety:

- Move the system using appropriate lifting equipment.
- Avoid heavy vibration during transport.

1.5 EMC Safety

All pan feeder system components comply with IEC EN 61000-6-3, the emission standard for residential, commercial, and light industrial environments.

2. Introduction

The control pan selector switch enables selecting which control pan will be used.

1. During brooding, move the switch to **MID** to select the intermediate control pan



2. When the birds are grown, move the switch to **END** to select the end control pan (located near the motor)

The control pan selector switch is assembled on the motor's electrical junction box

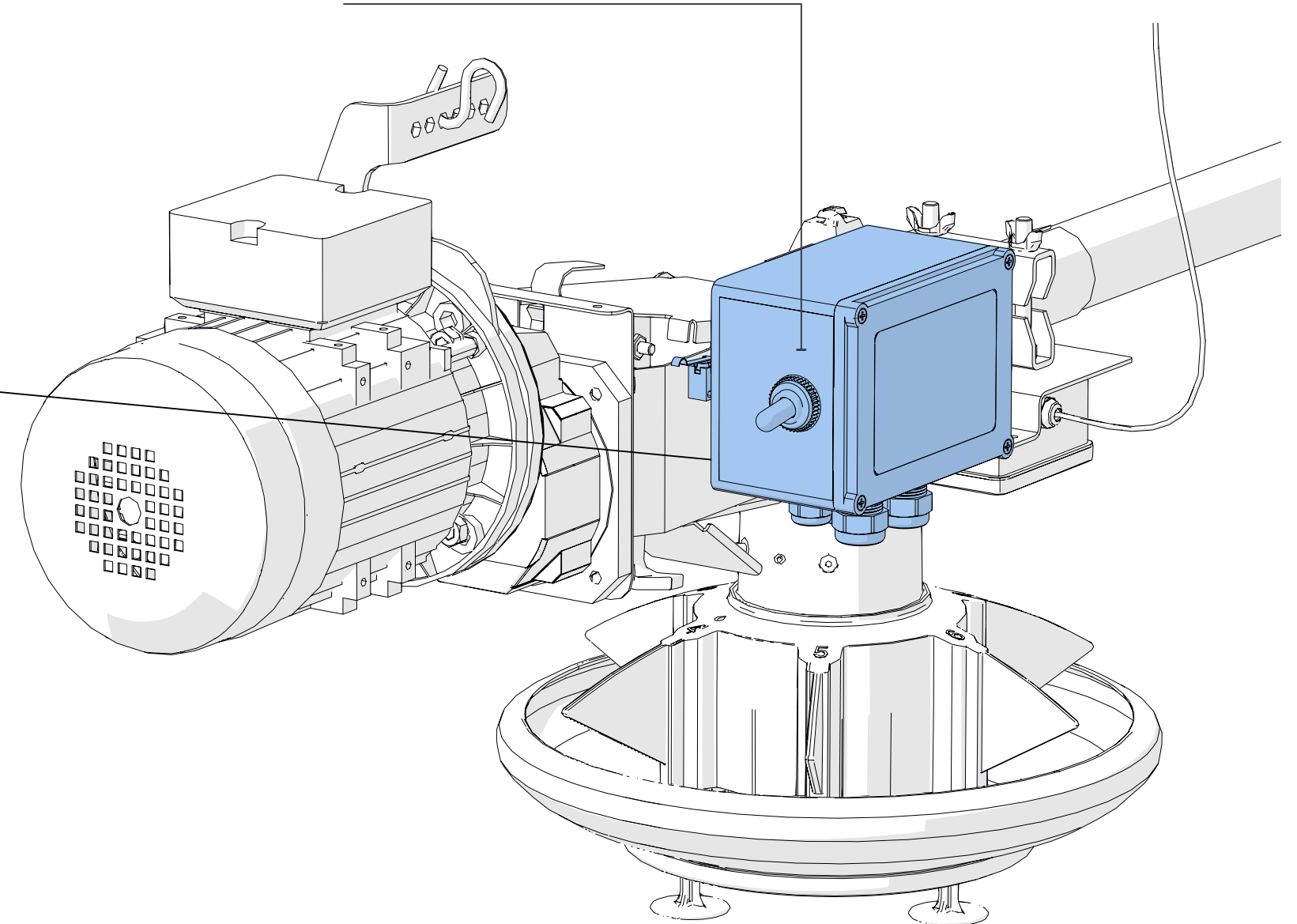

3. Assembly Instructions

Perform the following steps to install the control pan selector switch:

1. Apply the sticker on the left side of the electricity junction box (when facing the box lid), verifying the writing is upright

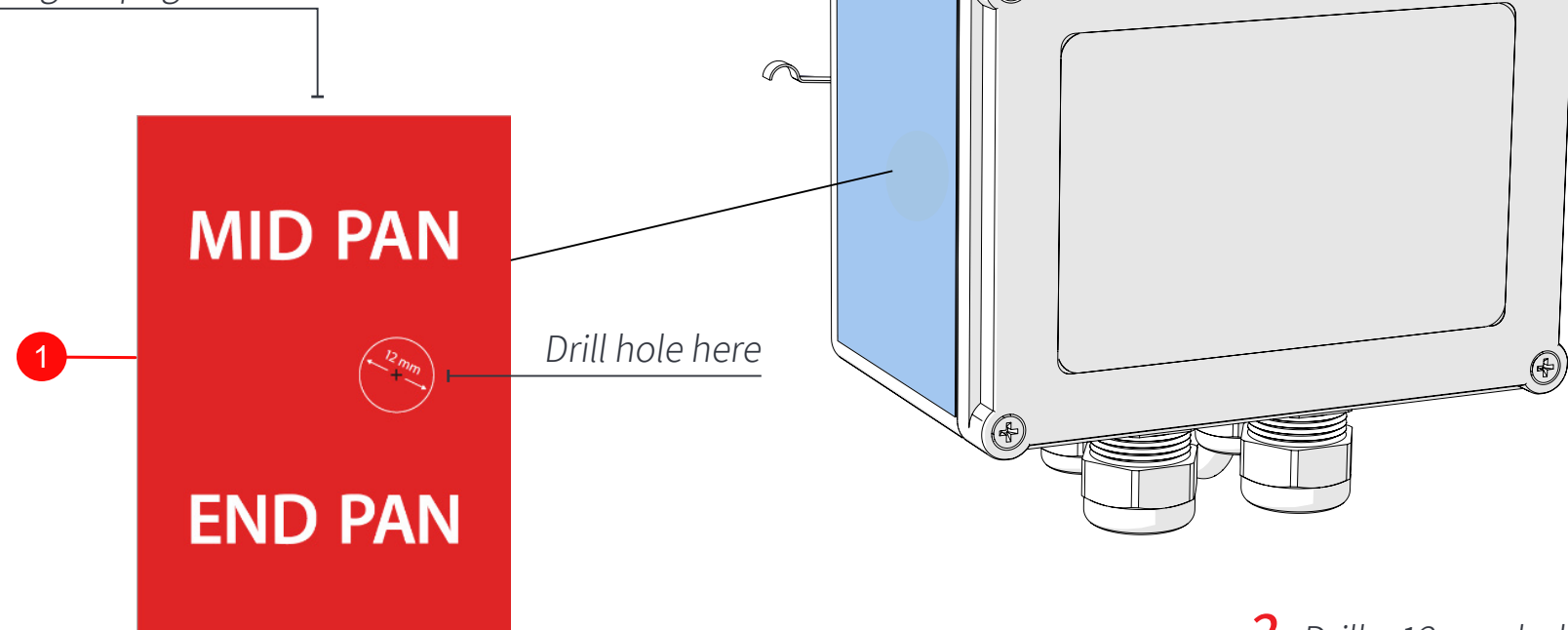

2. Drill a 12 mm hole through the electricity junction box at the position indicated on the sticker

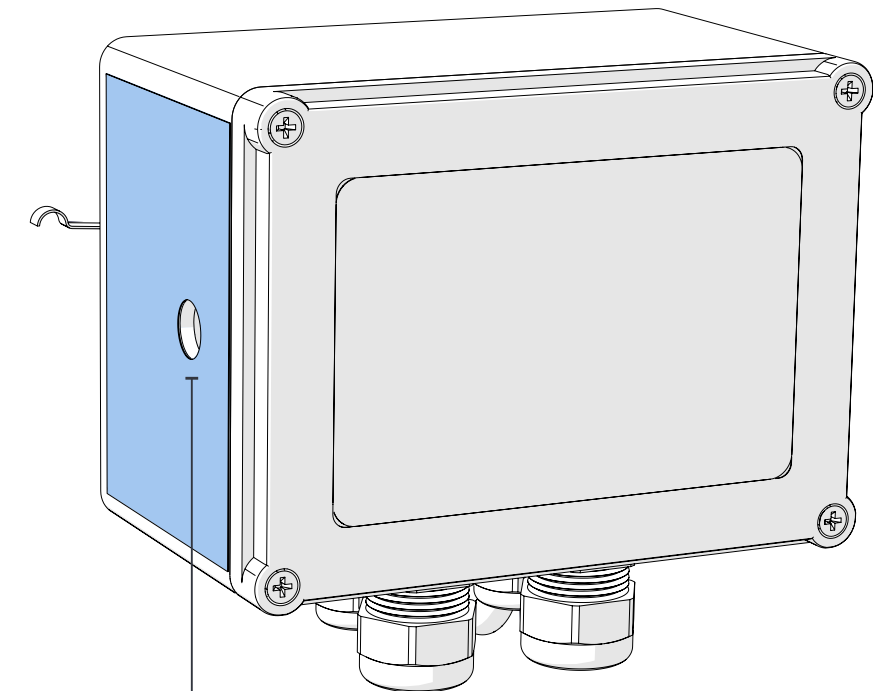

3. Clean out any burrs produced by the drilling

CAUTION

- Installation must be done by a qualified electrician or by someone specifically trained to install the selector switch.
- Before installation, verify that the main power supply is switched off and that it's locked/tagged out.

4. Remove the junction box lid

5. Insert the toggle switch (2) into the hole from the inside of the box

6. Fasten the protective cover (3) firmly onto the switch from the outside

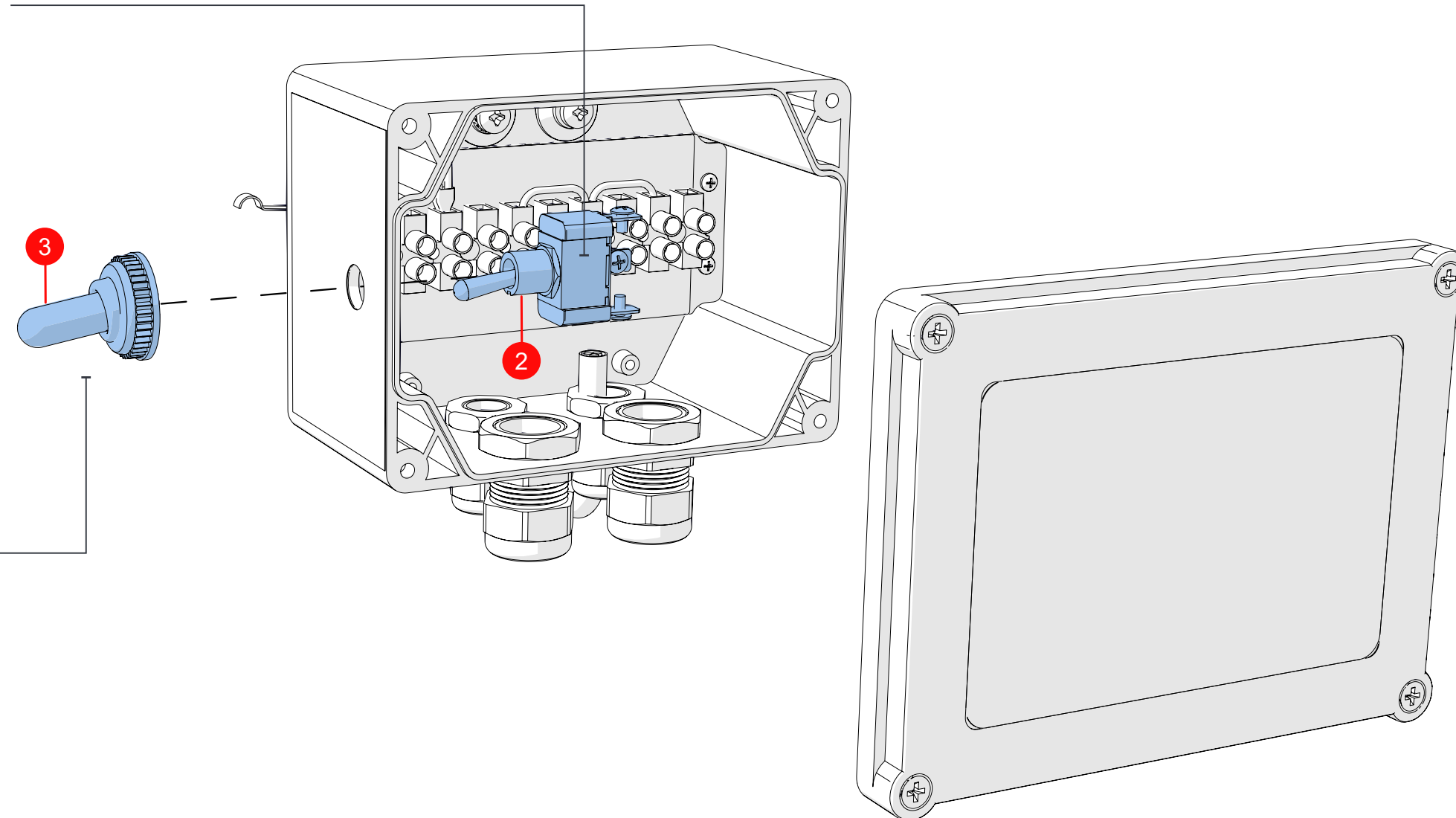

4. Wiring Instructions

Perform the following step to wire the toggle switch to the junction box:

1. Remove the bridge connecting the **MID TOGGLE LEG** and **UPPER TOGGLE LEG** terminals (marked in red)

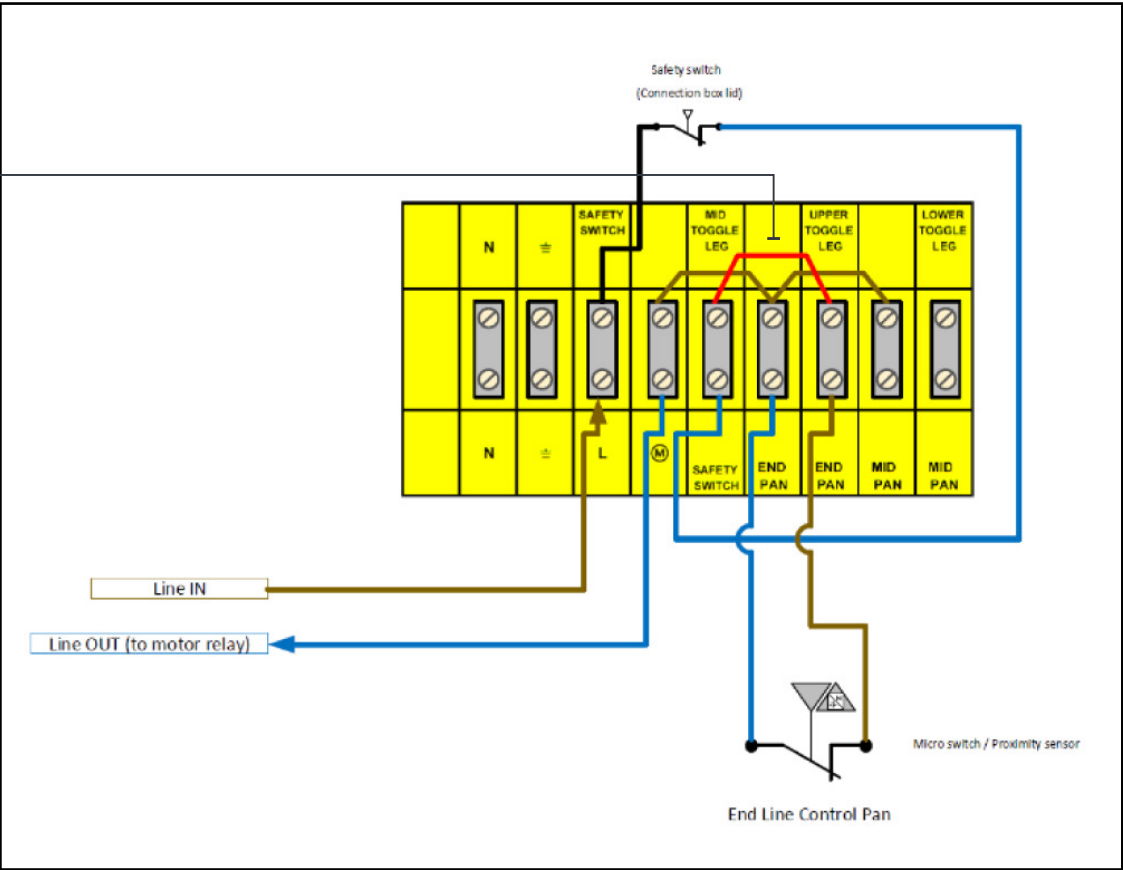
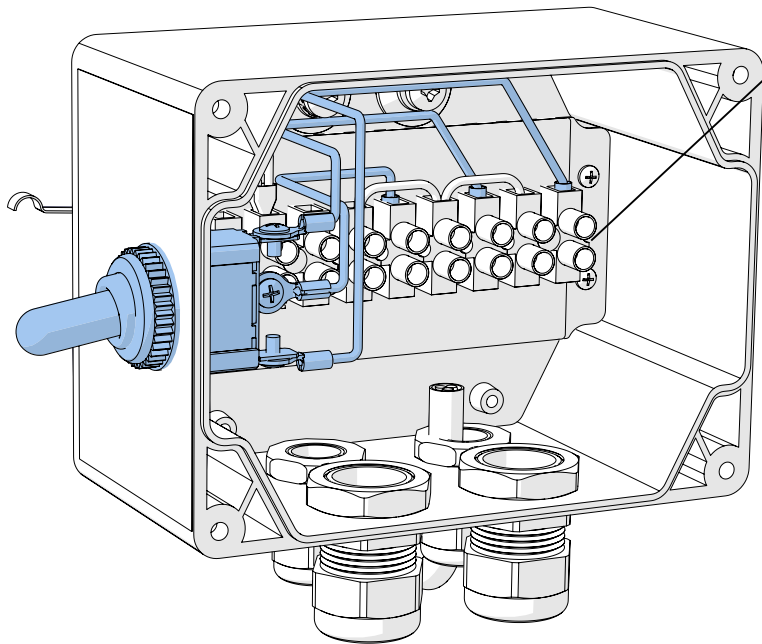

2. Connect each toggle switch wire to the appropriate terminal in the junction box, as indicated by the terminal stickers

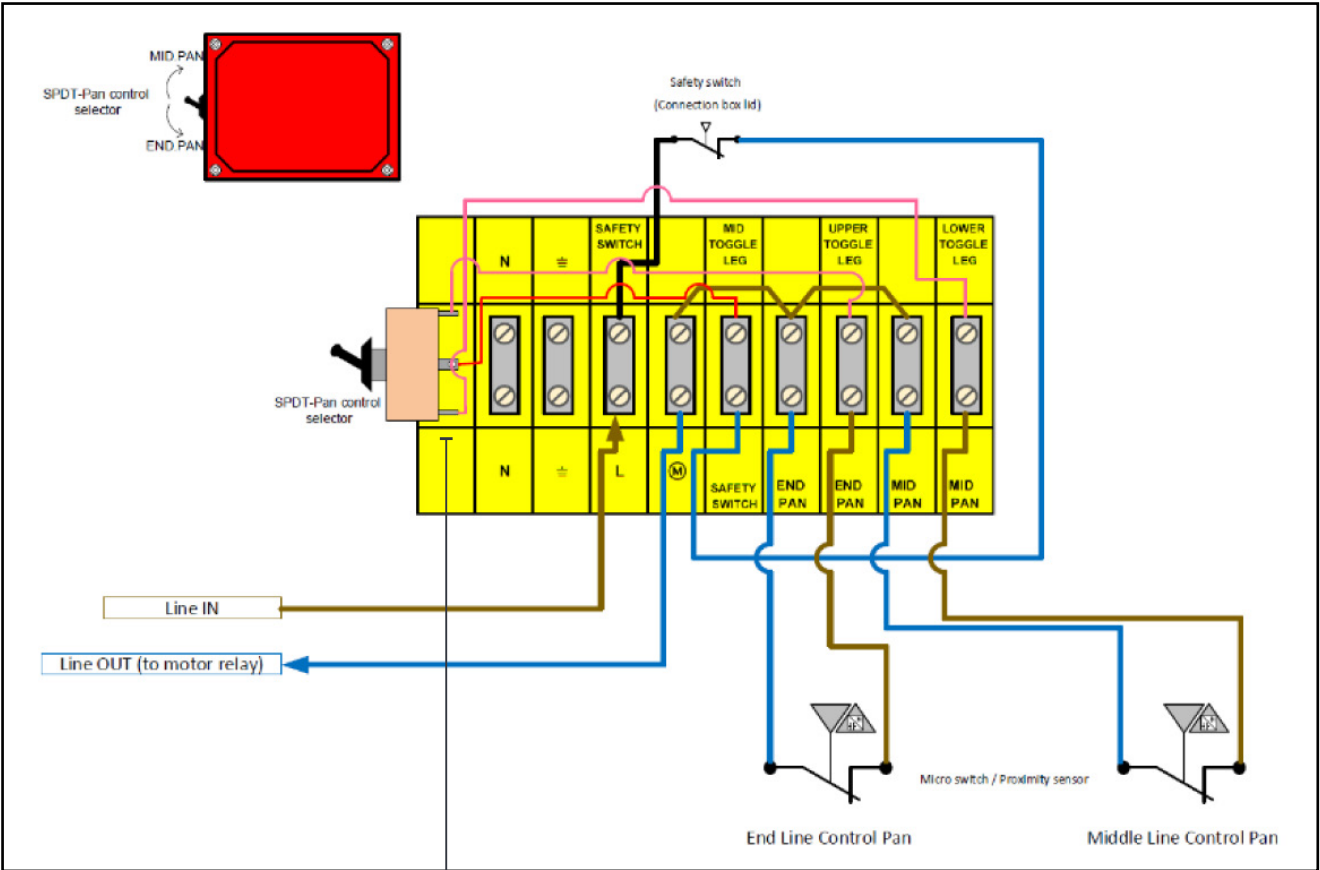

3. Test the switch to verify that the correct pan operates according to the switch position

5. Components List

The following table displays the list of parts required to assemble the control pan selector switch:

ID#	P/N	Description	QTY
--	02313194	CONTROL PAN SELECTOR SWITCH SET	1
The control pan selector switch set includes:			
1	02313192	SELECTOR SWITCH STICKER	1
2	02382446	TOGGLE SWITCH	1
3	02313196	TOGGLE SWITCH PROTECTIVE COVER	1



Feeding



Drinking



Climate



Housing



Plasson Livestock
Maagan Michael, D.N. Menashe
3780500 Israel



info@plassonlivestock.com



+972-73-2413001



<https://www.plassonlivestock.com>

Thank you!

Copyright © 2022 Plasson, all rights reserved. No part of this publication may be reproduced, transmitted, transcribed, stored in a retrieval system, or translated into any language or computer language, in any form or by any means, electronic, mechanical or otherwise without prior written permission of Plasson.